

4

3

2

1

- 1.0 GENERAL NOTES  
 1.1 ALL METRIC DIMENSIONS ARE IN BRACKETS [X.X]  
 1.2 FOR PATENT INFO: <https://www.adwpat.com>  
 2.0 DESIGN NOTES  
 3.0 MANUFACTURING/SPECIAL REQUIREMENTS  
 3.1 TIGHTEN ALL BOLTS 3/8" OR LARGER SECURING FLAT PLATES SNUG TIGHT. TIGHTEN ALL THREADED RODS SNUG TIGHT, WITH ATTENTION TO LEAVE EQUAL DISTANCE AND EQUAL FORCE ON EACH LEG OF THREADED ROD.  
 3.2 SNUG TIGHT IS DEFINED AS THE CONDITION OBTAINED WITH A FEW IMPACTS OF AN IMPACT WRENCH OR THE FULL EFFORT OF AN INSTALLER USING AN ORDINARY SPUD WRENCH TO BRING THE CONNECTED LAYERS (PLIES) OF STEEL INTO FULL CONTACT.  
 3.3 FOR BOLTS IN A PATTERN, TIGHTEN IN A CRISS-CROSS OR STAR SEQUENCE, INCREASING TORQUE IN GRADUAL STEPS UNTIL SNUG TIGHT.  
 4.0 TEST  
 5.0 PACKAGING  
 5.1 PACKAGING SHALL MEET ANDREW REQUIREMENTS PER DOCUMENT IS-PL-3005  
 5.2 PRINTED DOCUMENT TO BE PLACED INSIDE POLYBAG AND THEN IN SHIPPING CONTAINER  
 5.3 EXTRA HARDWARE MAY BE SUPPLIED, BAGGED AND SHIPPED

REVISIONS			
REV.	DESCRIPTION	DATE	ECN
T	UPDATE SMU2080.06 AND SMU2080.04	MSM 05/06/09	
U	UPDATE ISO VIEW	MSM 09/25/12	
V	UPDATED DESIGN & FROMAT	RJC 06/25/18	8000030482
W	REPLACED 3/4 HDW WITH 5/8 HDW	RJC 08/23/18	8000031008
Y	UPDATED DRAWING TO NEW FORMAT	RY1002 19JAN26	BA1025 50106611AMO

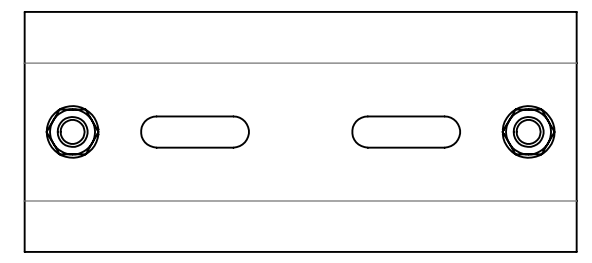
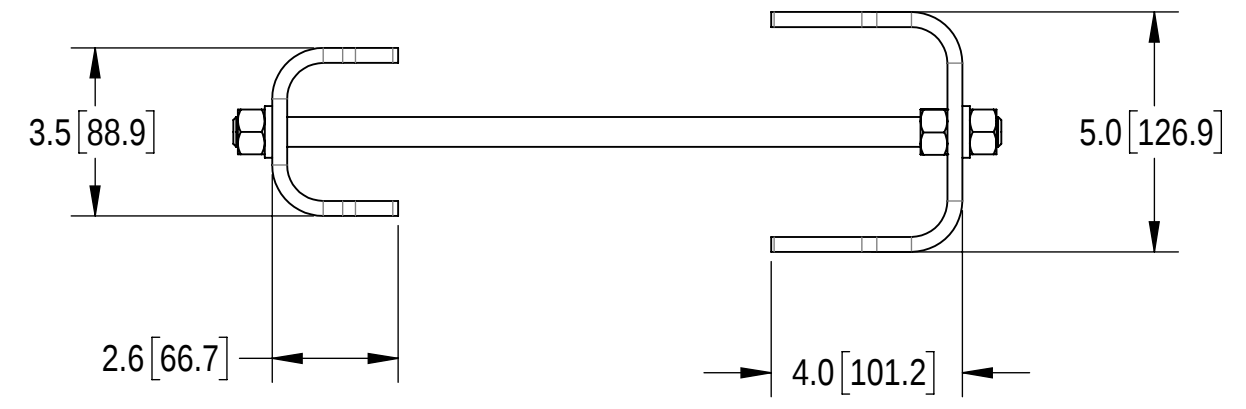
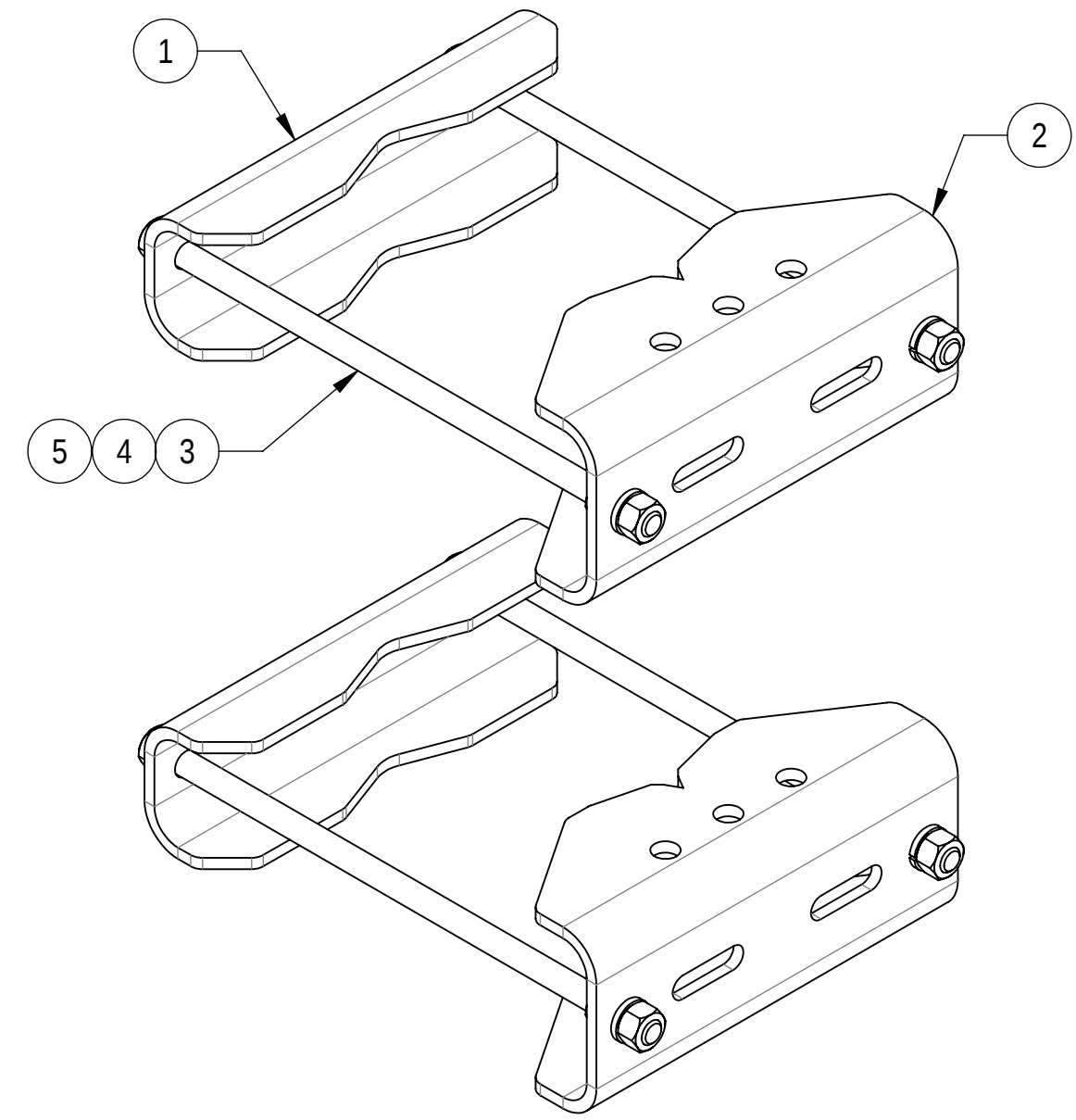
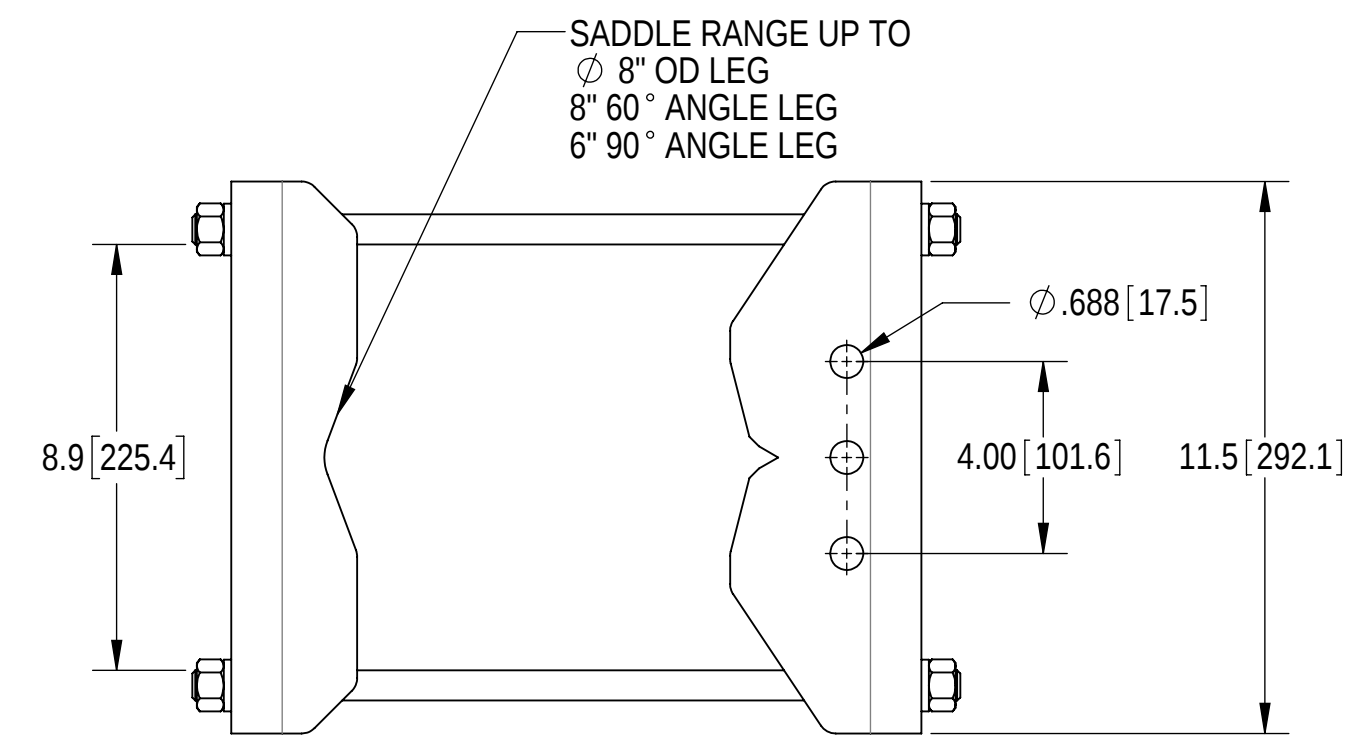

COMPONENT PART NUMBERS PROVIDED FOR ASSEMBLY PURPOSES;  
 INDIVIDUAL COMPONENTS MAY BE SHIPPED AS PARTS WITHIN AN INCLUDED KIT.

ITEM	PART NO.	DESCRIPTION	QTY.	WEIGHT	NOTE NO.
1	MTC397521	CLAMP, BACK	2	6.94 LBS	
2	MTC397522	CLAMP, FRONT MOUNTING	2	10.02 LBS	
3	MT-382-16	5/8" X 16" GALV THREADED ROD	4	1.38 LBS	
4	GNL-05	5/8" GALV LOCK WASHER	8	0.03 LBS	
5	GN-05	5/8" GALV HEX NUT	12	0.08 LBS	

DENSITY	40.65	lbs/in <sup>3</sup>
MASS	40.65	lbs
VOLUME	71.82	in <sup>3</sup>
SURFACE AREA	511.46	in <sup>2</sup>
HEIGHT	16.0"	
LENGTH	16.0"	
WIDTH	11.5"	

**ANDREW** an Amphenol company

TOLERANCES: 0 PLACE X[X] ± 0.25[6.4], 1 PLACE .X[X] ± 0.06[1.5], 2 PLACE .XX[X] ± 0.03[0.8], ANGLES ± 2°

SAP MATERIAL MASTER: SM-U2080

FINISH: MATERIAL

UNLESS OTHERWISE SPECIFIED DIMENSIONS ARE IN INCHES INTERPRET PER ANSI Y 14.5M-1994

NAME	DATE	TITLE
CE AW	10/20/04	UNIVERSAL SADDLE MOUNT, 2"-8" LEGS
RW RY1002	02/05/2026	
AD YMENG	02/05/2026	
RE YMENG	02/08/2026	
ECN 50106611AMO		

SCALE: 1:4 DOCUMENT NO.: SM-U2080

SIZE	Auth Group	INSL	MODEL	DRAWING			SHEET		
C			VERSION	STATUS	REVISION	VERSION	STATUS	REVISION	1 OF 1
			02	RE	W	02	RE	Y	

4

3

2

1

Confidential